



Leo

Circular suspension with double ring with opal diffuser. Thanks to the double ring, one 600 mm and the other 400 mm both with direct light, this suspension guarantees a good level of illuminance. Only available in 3000K version, white or black finish. It has a source emission of about 5320lm. Design and size make Leo an elegant decorative and furnishing element, its performance makes it very versatile. Leo adapts to all environments, even large ones. Perfect for reception (reception, cash desks, hall) and suitable for general lighting of shops, bars, restaurants and meeting rooms, also suitable for the home environment.

Code	6993-22-956
Type	Suspension lamp
Eancode	8019282553533
Customs tariff	94051190
Color	White
Material	Aluminum white frame / Opal white diffuser
IP	IP20
IK	07
Insulation Class	 CL1
Operating ambient temperature	0°C +35°C
Item Dimensions	MAX 2000mm Ø600mm - 2.5kg
Packaging Dimensions	85x640x640mm - 3.4kg
Light Source 1	
Light source	LED Built-in
LED Characteristics	SMD
Light Source Lumen	5320 lm
Item Lumen	3700 lm
Color Temperature	Warm white 3000K
Optics	Diffused beam
Typical CRI	>80
Energy Efficiency Class	
Electrical specifications 1	
Input Voltage	220/240V AC 50/60Hz
Total Absorbed Power	52W
Driver	Included
Power Factor	>0,9
Control System	DALI

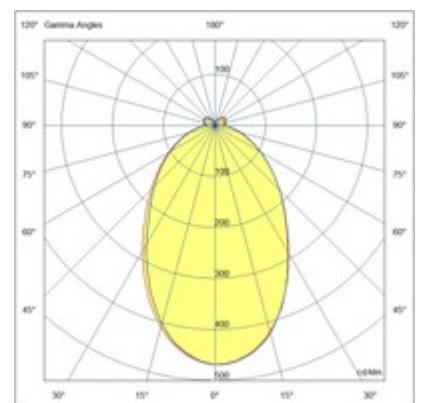
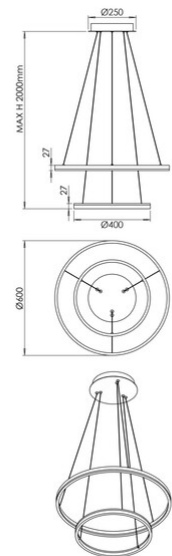

CE